

# PX 1390

PX 139 . . . . .

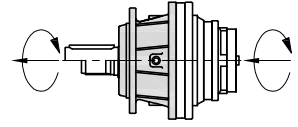

i	T <sub>2</sub> (Nm)						n <sub>1max</sub> (min <sup>-1</sup> )	T <sub>2max</sub> (Nm)	P <sub>t</sub> (kW)	
	n <sub>2</sub> x h									
	10000	25000	50000	100000	500000	1000000				
<b>1391</b>	<b>4.18</b>	351515	329500	373520	222000	136900	111200	200	570000	95
	<b>4.89</b>	295150	276600	229600	186400	115000	93400	200	487000	95
	<b>6.00</b>	233950	219200	181900	147500	91000	73900	200	386000	95
<b>1392</b>	<b>17.4</b>	351515	329500	373520	222000	136900	111200	500	570000	63
	<b>20.4</b>	351515	329500	373520	222000	136900	111200	500	570000	63
	<b>23.9</b>	295150	276600	229600	186400	115000	93400	500	487000	63
	<b>25.1</b>	351515	329500	373520	222000	136900	111200	500	570000	63
	<b>29.3</b>	295150	276600	229600	186400	115000	93400	500	487000	63
	<b>36.0</b>	233950	219200	181900	147500	91000	73900	500	386000	63
<b>1393</b>	<b>73.0</b>	351515	329500	373520	222000	136900	111200	1500	570000	40
	<b>85.3</b>	351515	329500	373520	222000	136900	111200	1500	570000	40
	<b>99.8</b>	351515	329500	373520	222000	136900	111200	1500	570000	40
	<b>105.0</b>	351515	329500	373520	222000	136900	111200	1500	570000	40
	<b>116.9</b>	295150	276600	229600	186400	115000	93400	1500	487000	40
	<b>122.4</b>	351515	329500	373520	222000	136900	111200	1500	570000	40
	<b>127.3</b>	351515	329500	373520	222000	136900	111200	1500	570000	40
	<b>143.3</b>	295150	276600	229600	186400	115000	93400	1500	487000	40
	<b>150.6</b>	295150	276600	229600	186400	115000	93400	1500	487000	40
	<b>177.6</b>	295150	276600	229600	186400	115000	93400	1500	487000	40
<b>216.0</b>	233950	219200	181900	147500	91000	73900	1500	386000	40	
<b>1394</b>	<b>259.3</b>	351515	329500	373520	222000	136900	111200	1500	570000	22
	<b>302.8</b>	351515	329500	373520	222000	136900	111200	1500	570000	22
	<b>354.3</b>	351515	329500	373520	222000	136900	111200	1500	570000	22
	<b>427.1</b>	351515	329500	373520	222000	136900	111200	1500	570000	22
	<b>497.8</b>	295150	276600	229600	186400	115000	93400	1500	487000	22
	<b>544.8</b>	351515	329500	373520	222000	136900	111200	1500	570000	22
	<b>685.4</b>	351515	329500	373520	222000	136900	111200	1500	570000	22
	<b>789.1</b>	295150	276600	229600	186400	115000	93400	1500	487000	22
	<b>843.4</b>	295150	276600	229600	186400	115000	93400	1500	487000	22
	<b>967.3</b>	295150	276600	229600	186400	115000	93400	1500	487000	22
	<b>1061.2</b>	351515	329500	373520	222000	136900	111200	1500	570000	22
	<b>1193.8</b>	295150	276600	229600	186400	115000	93400	1500	487000	22
	<b>1242.4</b>	295150	276600	229600	186400	115000	93400	1500	487000	22
	<b>1305.7</b>	295150	276600	229600	186400	115000	93400	1500	487000	22
	<b>1458.0</b>	233950	219200	181900	147500	91000	73900	1500	386000	22
<b>1872.7</b>	233950	219200	181900	147500	91000	73900	1500	386000	22	

# PXA 1390

PXA 139 . . . . .

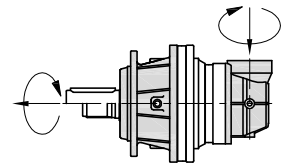

i	T <sub>2</sub> (Nm)						n <sub>1max</sub> (min <sup>-1</sup> )	T <sub>2max</sub> (Nm)	P <sub>t</sub> (kW)
	n <sub>2</sub> x h								
	10000	25000	50000	100000	500000	1000000			

<b>1394</b>	<b>258.4</b>	351515	329500	373520	222000	136900	111200	1500	570000	22
	<b>302.0</b>	351515	329500	373520	222000	136900	111200	1500	570000	22
	<b>353.3</b>	351515	329500	373520	222000	136900	111200	1500	570000	22
	<b>361.1</b>	351515	329500	373520	222000	136900	111200	1500	570000	22
	<b>369.3</b>	351515	329500	373520	222000	136900	111200	1500	570000	22
	<b>413.8</b>	295150	276600	229600	186400	115000	93400	1500	487000	22
	<b>433.3</b>	351515	329500	373520	222000	136900	111200	1500	570000	22
	<b>454.7</b>	351515	329500	373520	222000	136900	111200	1500	570000	22
	<b>507.3</b>	295150	276600	229600	186400	115000	93400	1500	487000	22
	<b>530.3</b>	351515	329500	373520	222000	136900	111200	1500	570000	22
	<b>551.2</b>	351515	329500	373520	222000	136900	111200	1500	570000	22
	<b>620.5</b>	295150	276600	229600	186400	115000	93400	1500	487000	22
	<b>652.1</b>	295150	276600	229600	186400	115000	93400	1500	487000	22
	<b>769.0</b>	295150	276600	229600	186400	115000	93400	1500	487000	22
<b>935.3</b>	233950	219200	181900	147500	91000	73900	1500	386000	22	

# PX / PXA 1390

**FMS**

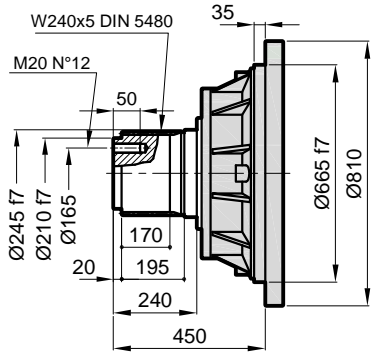

**FMC**

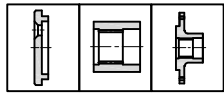
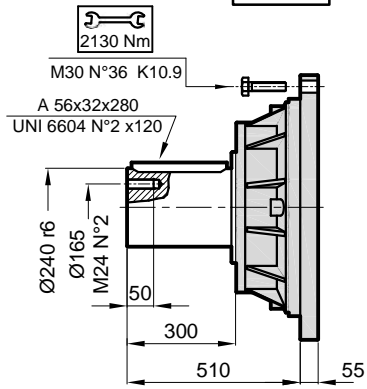

PX .....

PXA .....

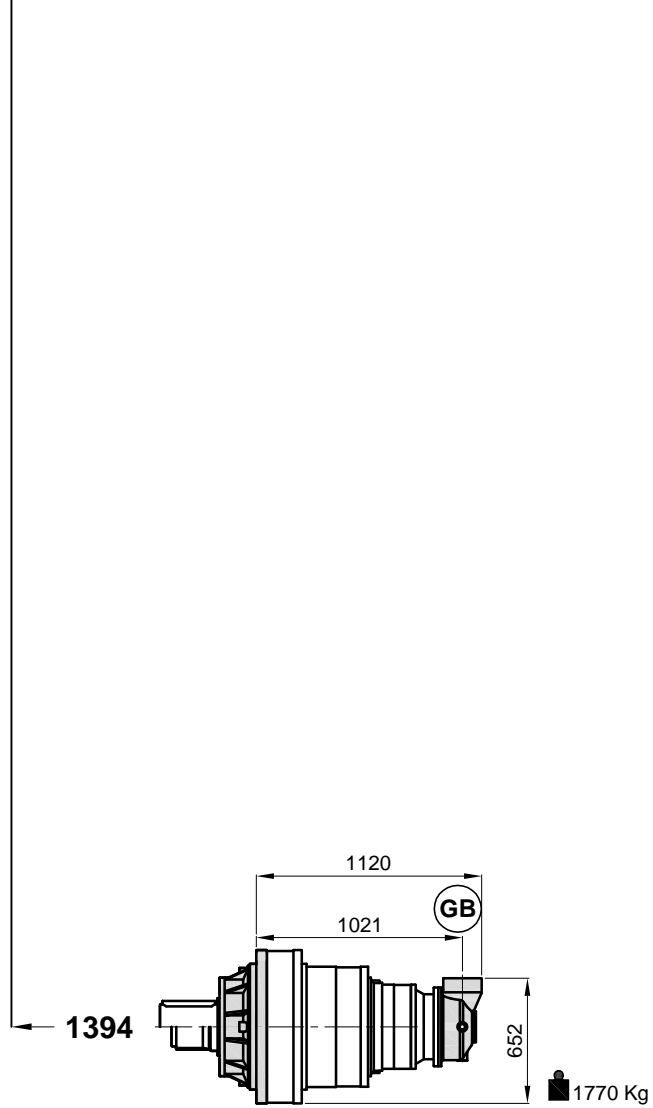
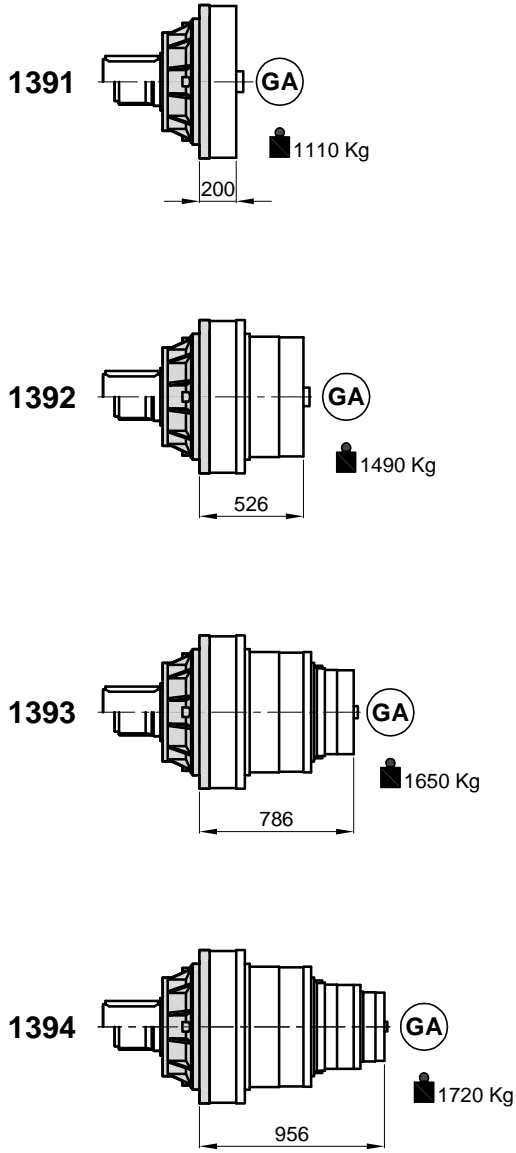

# PX / PXA 1390

FSS

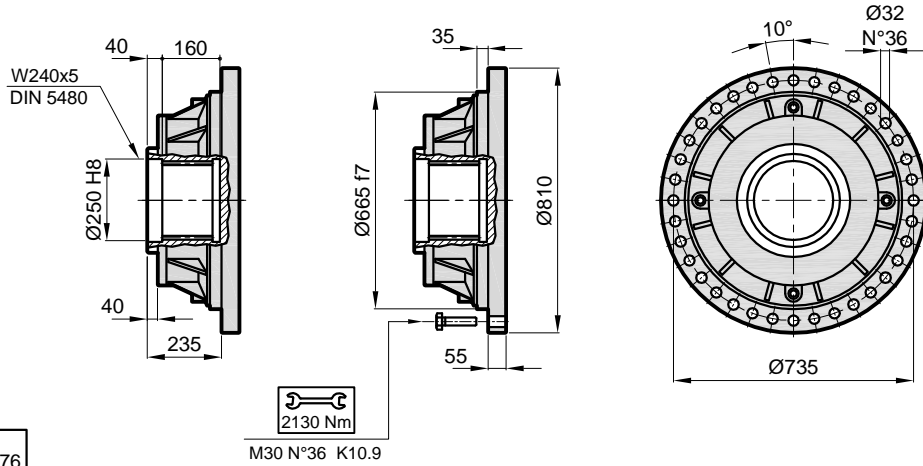

PX .....

PXA .....

1391

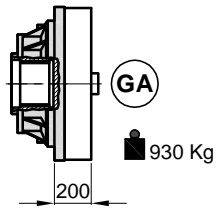

1392

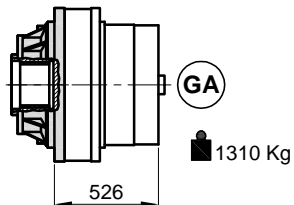

1393

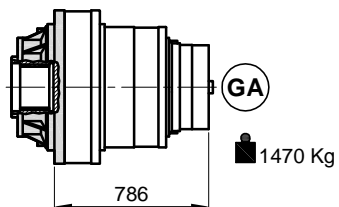

1394



1394

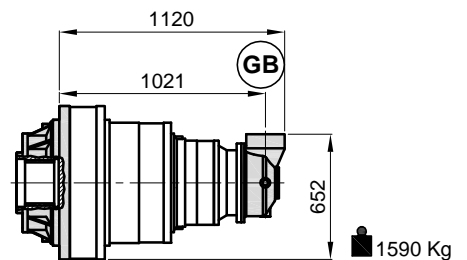

# PX / PXA 1390

**FSD**

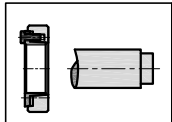
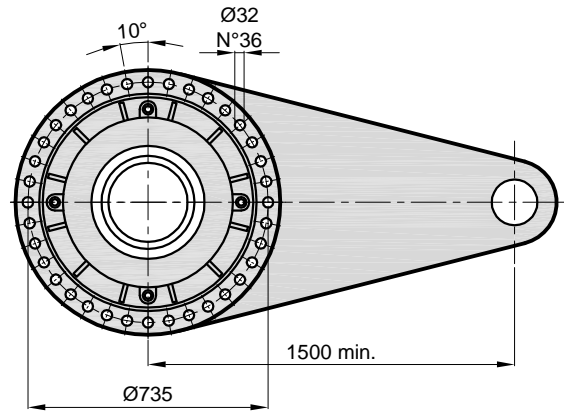
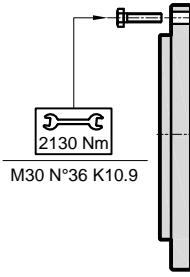
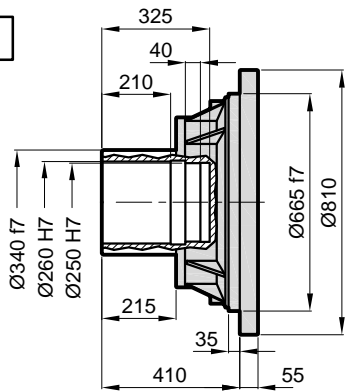

276

$M_{max} = 603 \text{ kNm}$

Maksimum tork de eri Planex tarafından verilen sıkma bilezi i ile sa lanır.  
The maximum torque indicated is valid only with shrink discs supplied by Planex.  
Das dargestellte , maximale Drehmoment gilt nur mit von Planex.

**PX** .....

**PXA** .....

1391

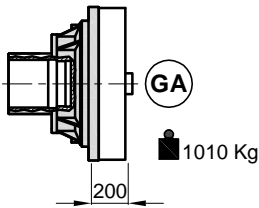

1392

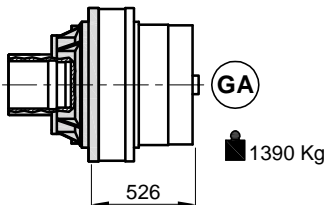

1393

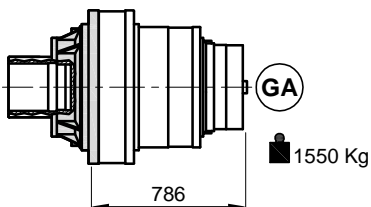

1394

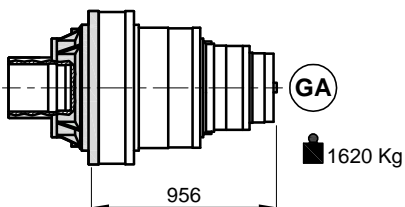

1394

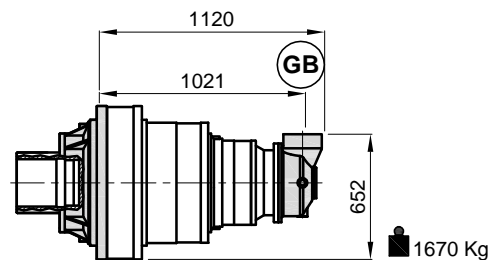

# PX / PXA 1390

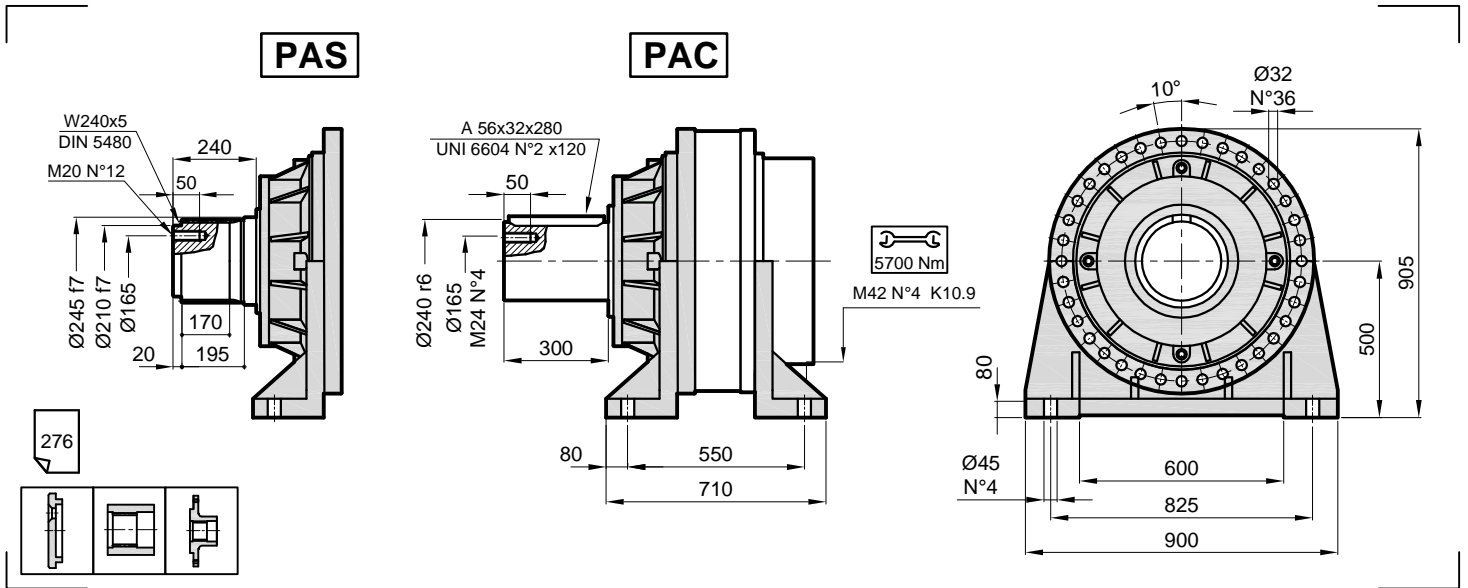

PX .....

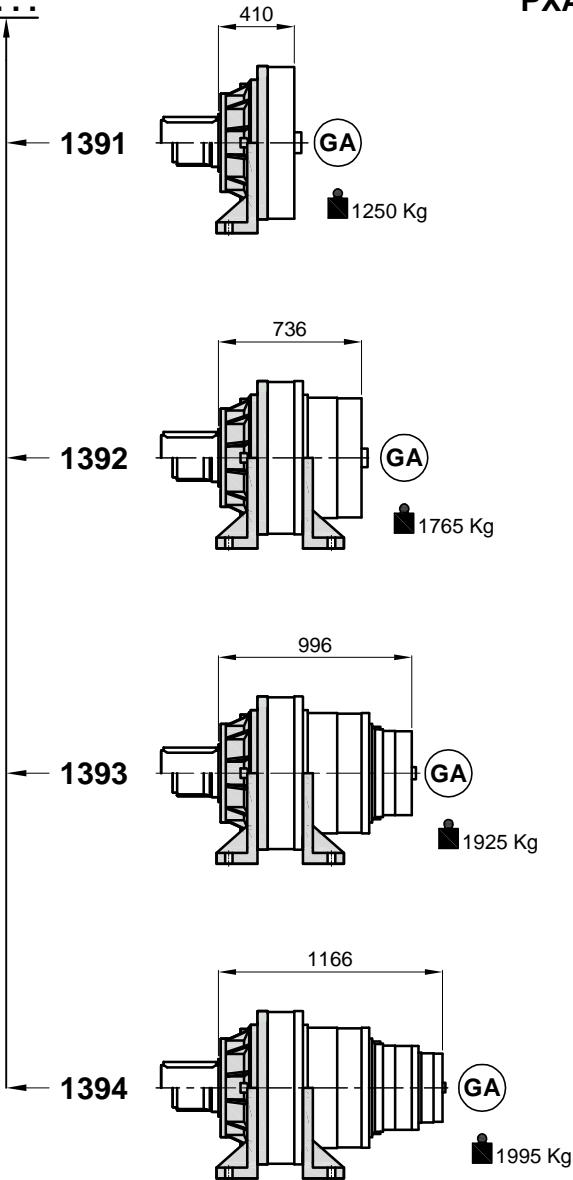

PXA .....

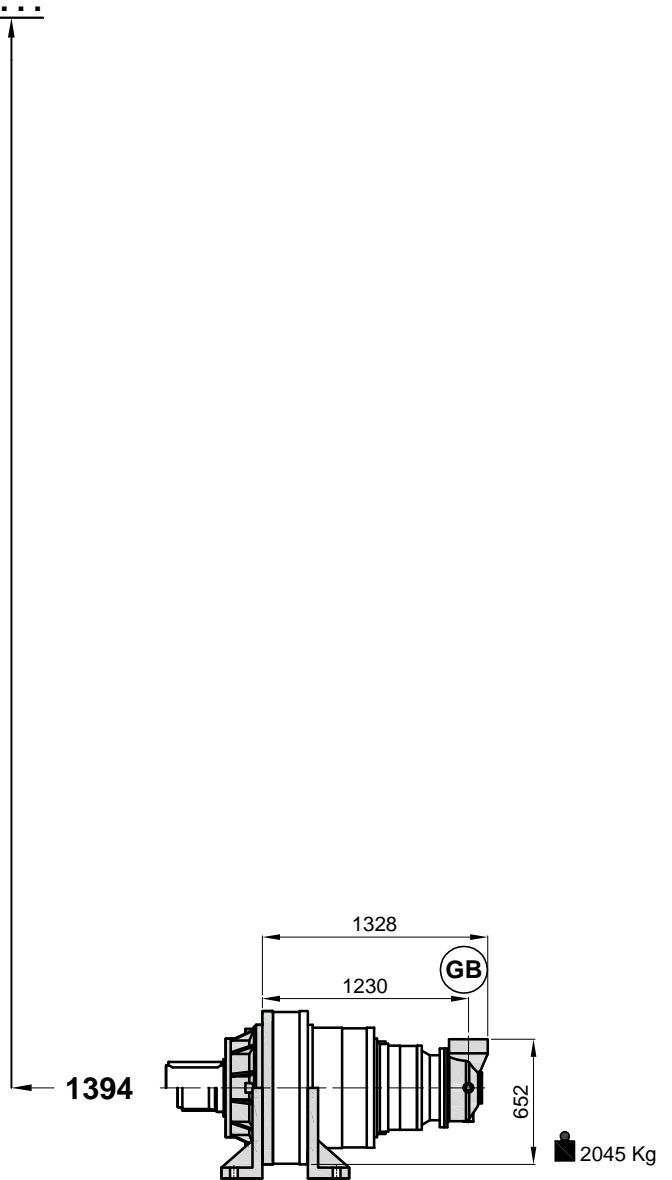

# PX / PXA 1390

ET

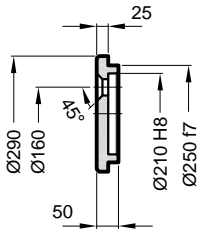

MC

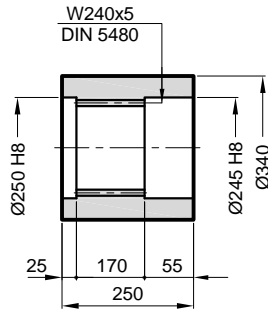

Malzeme / Material / Material  
C40

Kod / Code / Bestell  
1390.100.001

TF

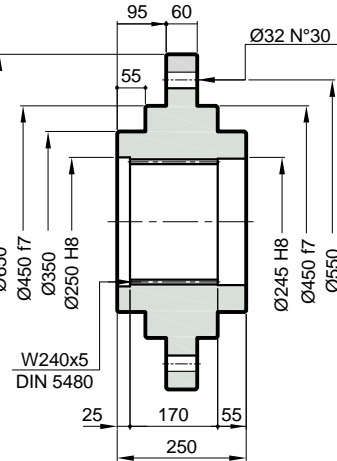

Malzeme / Material / Material  
C40

Kod / Code / Bestell  
1390.100.003

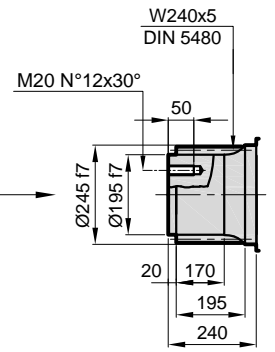

SD

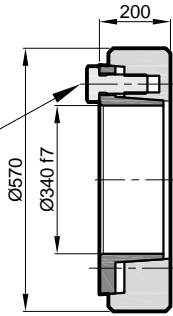
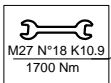

Maksimum tork  
Max. torque  
Max. Drehmoment  
603 kNm

Kod / Code / Bestell  
1390.100.004

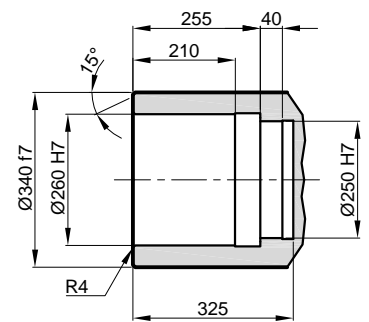
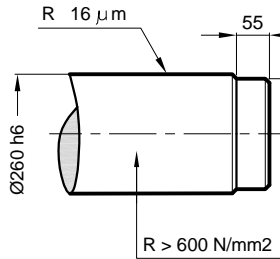

SM

W240x5  
DIN 5480

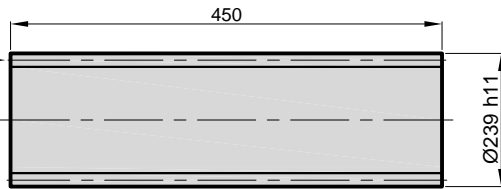

Malzeme / Material / Material

UNI 39NiCrMo3  
Sertle tirilmi ve Temperlenmi  
Hardened and Tempered  
Vergütet

Kod / Code / Bestell  
1390.100.005

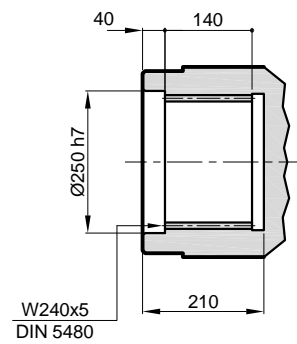

W240x5  
DIN 5480

# PX / PXA 1390

**GA**

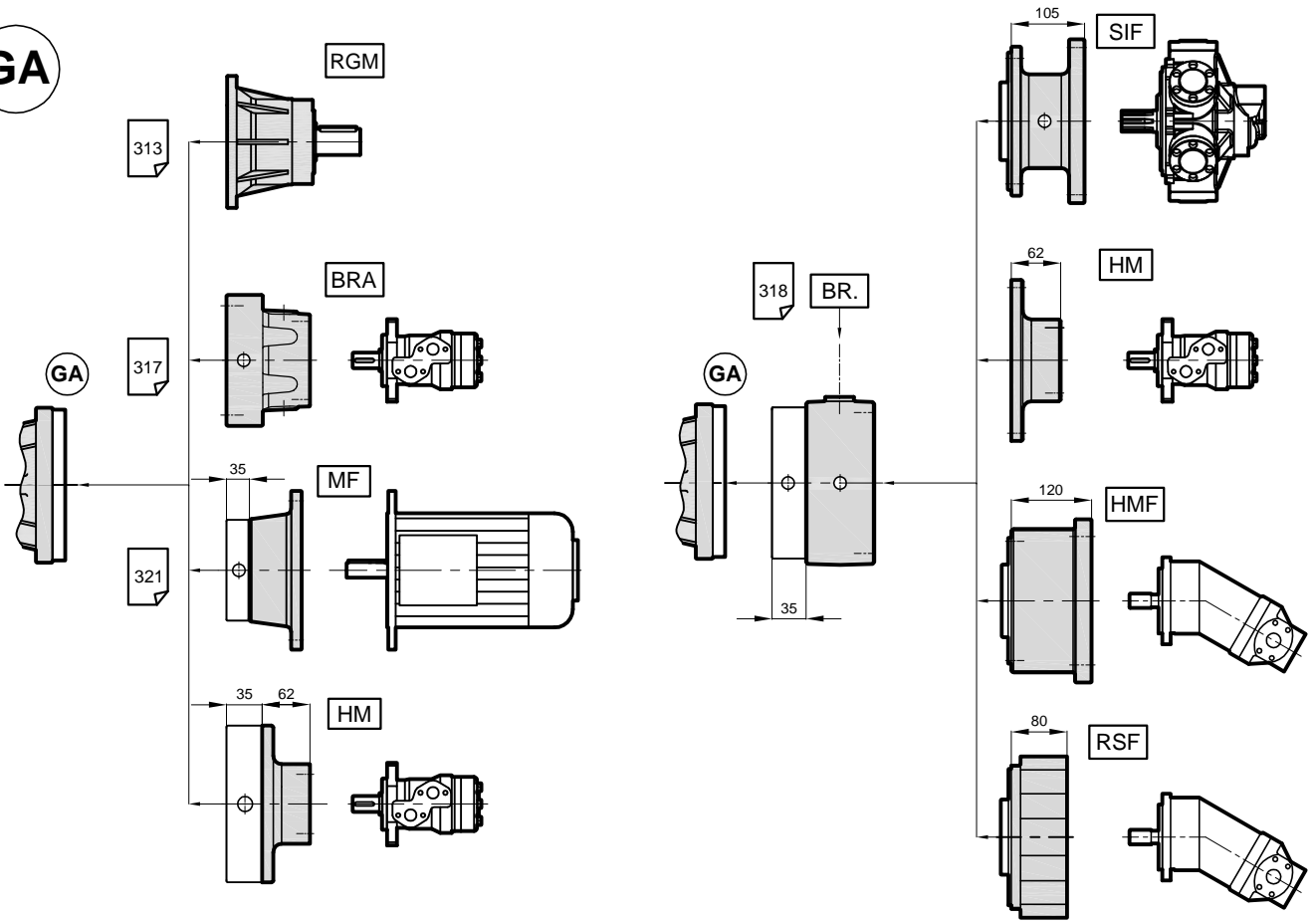

**GB**

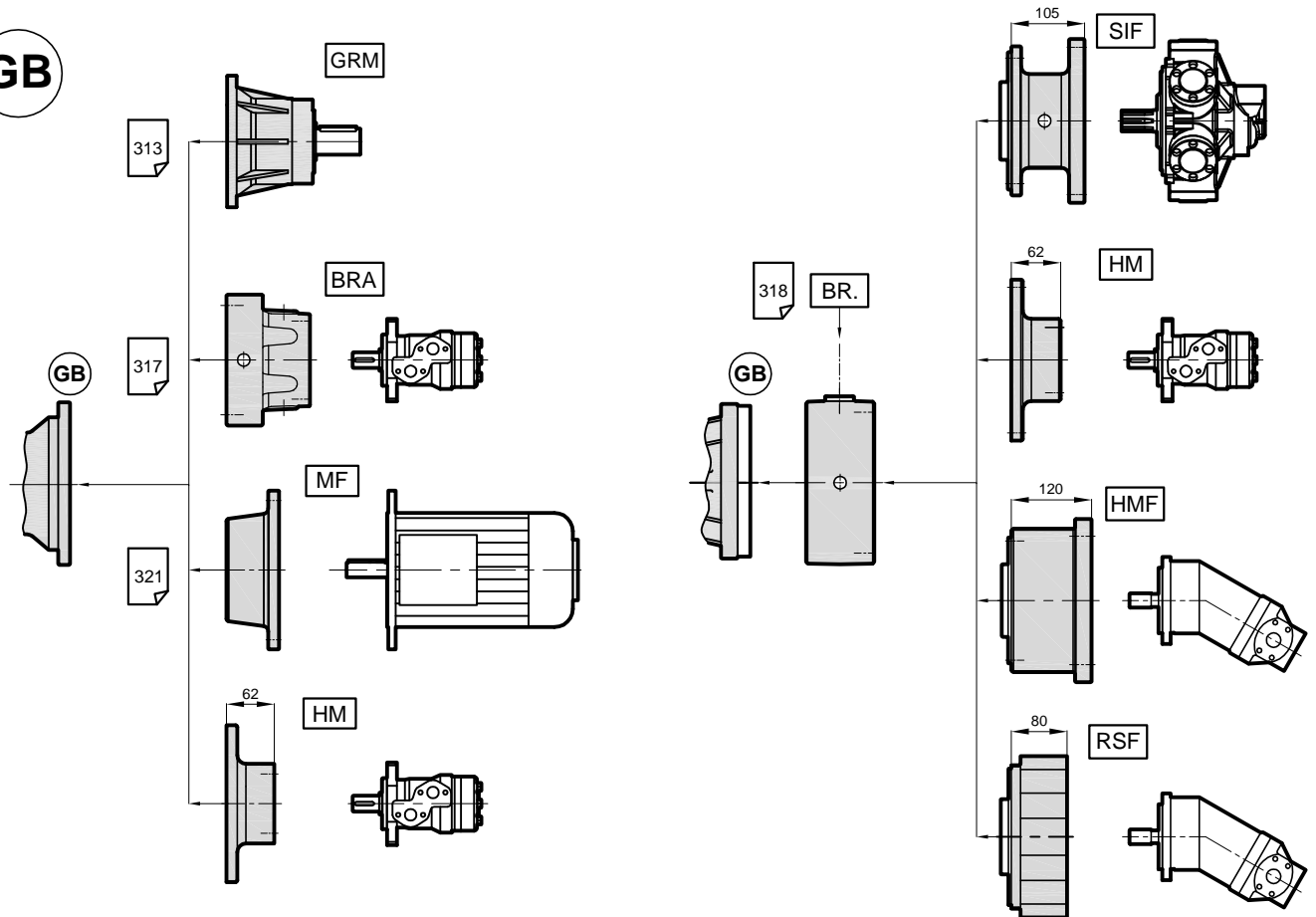



# PX / PXA 1390

## Radyal Yük ( $F_{rp}$ )

Aşağıdaki diyagramlar radyal yükleri ve  $K$  faktörlerini arzu edilen  $n_2 \times h$  değerlerinde verir.

## Radial Loads ( $F_{rp}$ )

The following curves show the radial loads and the  $K$  factors to obtain the required  $n_2 \times h$  value.

## Radiallast ( $F_{rp}$ )

In den nachstehenden Diagrammen ist die Radiallast und der Koeffizient  $K$  dargestellt und kann mit dem gewünschten Wert  $n_2 \times h$  verglichen werden.

### FM - PA

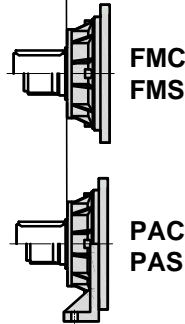
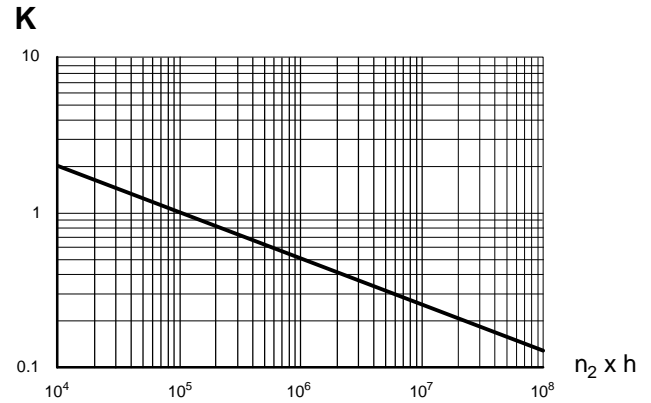
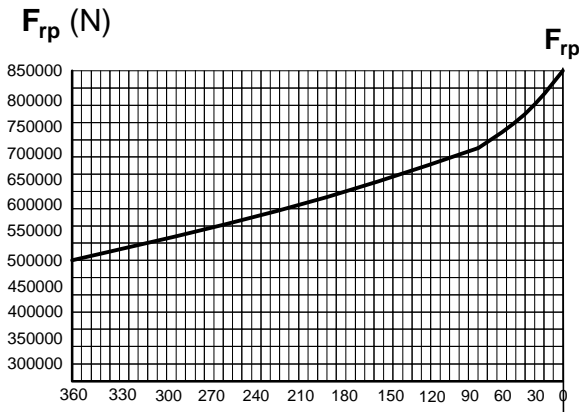

	$n_2 \times h$				
	$10^5$	$10^4$	$10^6$	$10^7$	$10^8$
FM	$F_{rp}$	$F_{rp} \cdot K$			
PA	$F_{rp} \cdot 0,75$	$F_{rp} \cdot K \cdot 0,75$			

## Aksiyel Yük ( $F_a$ )



Tablodaki aksiyel yük değerleri çıkış tipi ve tatbik edilen yük yönünde verilmiştir.

## Axial Loads ( $F_a$ )

The values of the axial loads in the table refer to the output versions and load directions of application.

## Axiallast ( $F_a$ )

Die dargestellten Werte der Axiallast basieren auf der Version und der applizierten Lastrichtung.

$F_a$ (N)	FM	PA	
	100000	100000	
120000	120000	120000	

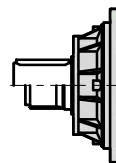

FMC  
FMS

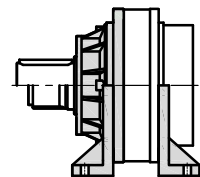

PAC  
PAS